

LUMIO

BATHROOM  
WALL LIGHT

• • •

KERRY

10W Bathroom Wall Light - TRI CCT

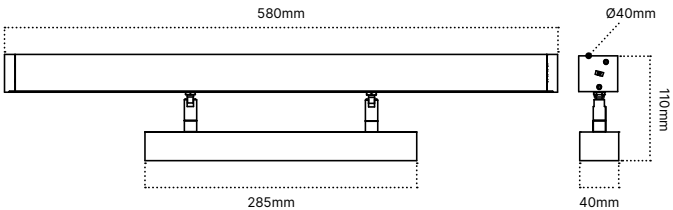

Voltage		220 - 240V~ 50Hz	
Power consumption		10W	
	Warm White	Cool White	Daylight
Colour temperature	3000K	4000K	5700K
Lumens	1055m	1165lm	1000lm
Warranty		3 Years	
Working temperature		-5 – 45 °C	
IP Rating		IP40	

Installation

1. Turn off mains supply.
2. Carefully remove mounting bracket from light base by unscrewing two retaining screws using a philips using a philips-head screwdriver.
3. Mount wall bracket in place, using rawl screws if required. Ensure that wall bracket is level and is securely held in place.
4. Terminate cables into the terminal block ensuring the correct polarity. Ensure all conductors are fully insulated.
5. Fit lamp body to the mounting bracket, taking care to ensure that mains cable does not become damaged or trapped.
6. Select required light colour temperature, using switch on side of light head, turn on mains supply.

Safety information

Read instructions carefully before installation.  
Failure to follow instructions may result in electric shock, fire and/or serious injury.

Save these instructions

- Do not attempt to install this product if the unit or cord is damaged – return the product to the retailer for replacement.
- Do not install this product on damp or newly plastered ceilings.
- The light source of this luminaire is not replaceable; when the light source reaches its end of life the whole luminaire shall be replaced.
- This product must only be installed by a licensed electrician.

1.

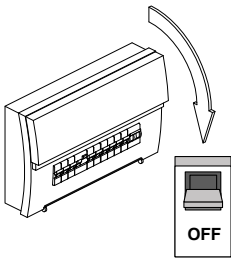

2.

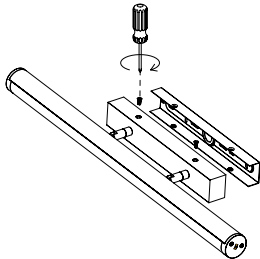

3.

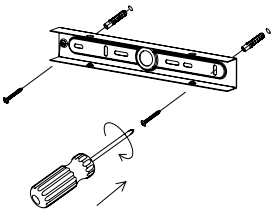

4.

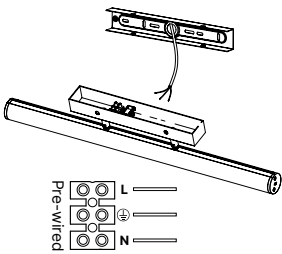

5.

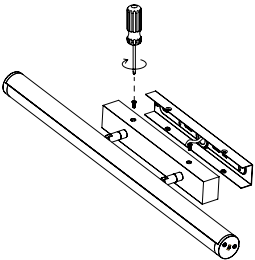

6.

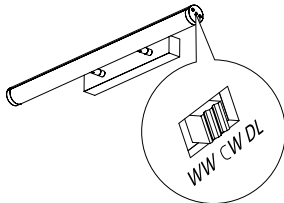

**Warranty**

Any claim under this warranty must be made within 3 years of the date of purchase of the product. To make a claim under the warranty, take the product (with proof of purchase) to any Bunnings store (see [www.bunnings.com.au](http://www.bunnings.com.au) for store locations) or contact Evolt Pty Ltd.

Evolt Pty Ltd bears reasonable, direct, expenses of claiming under the warranty. You may submit details and proof to Evolt Pty Ltd for consideration. The warranty covers manufacturer defects in materials, workmanship and finish under normal use.

This warranty is provided in addition to other rights and remedies you may have under law: our goods come with guarantees which cannot be excluded under the Australian Consumer Law.

You are entitled to replacement or refund for a major failure and to compensation for other reasonably foreseeable loss or damage. You are also entitled to have the goods repaired or replaced if the goods fail to be of acceptable quality and the failure does not amount to a major failure.

The warranty excludes damage resulting from product misuse or product neglect. The warranty covers domestic use only and does not apply to commercial applications.

This warranty is given by Evolt Pty Ltd, ABN 83 112 123 529, Unit 5, 105a Vanessa St, Kingsgrove, NSW 2208, 1300 438 658, [sales@evolt.com.au](mailto:sales@evolt.com.au)

17737 17738

V1.1

**Lumio is a registered brand of Evolt Pty Limited.**

For further information please call Evolt's head office on 1300 4EVOLT (438 658).  
Evolt Pty Limited PO BOX 271 KINGSGROVE NSW 1480  
ABN 83 112 123 529

Due to changes in industry standards and Evolt's policy of continual product development, product specifications are subject to change without notice.  
Images are for illustrative purposes only.

For more information please visit our website  
[www.evolt.com.au](http://www.evolt.com.au)

a brand of | **evolt**

.....  
This product may contain substances that can be hazardous to the environment if not disposed of properly. Electrical and electronic equipment should never be disposed of with general household waste but must be separated of it's correct treatment and recovery. Where possible recycle your packaging. Please keep these instructions safe for future reference.